

ACCENT PAVING →

EXISTING TREES

"SCULPTURE"

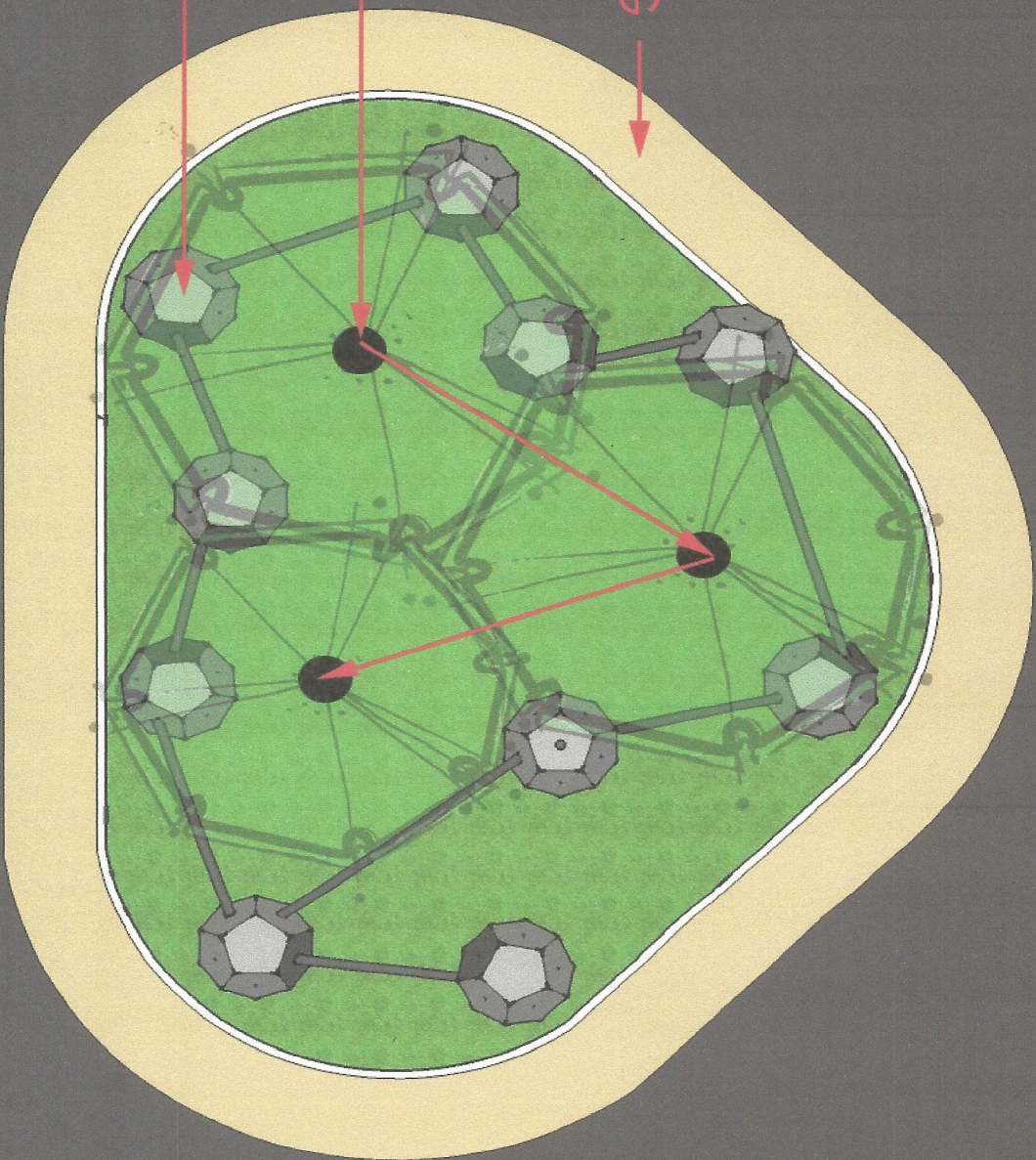









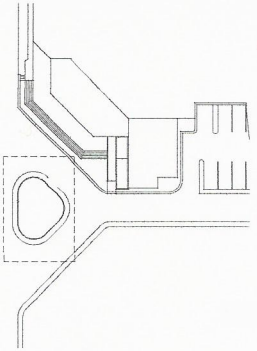

KEY PLAN

DODECAHEDRON
BLOCKS

EXISTING TREES
VERIFY ON SITE

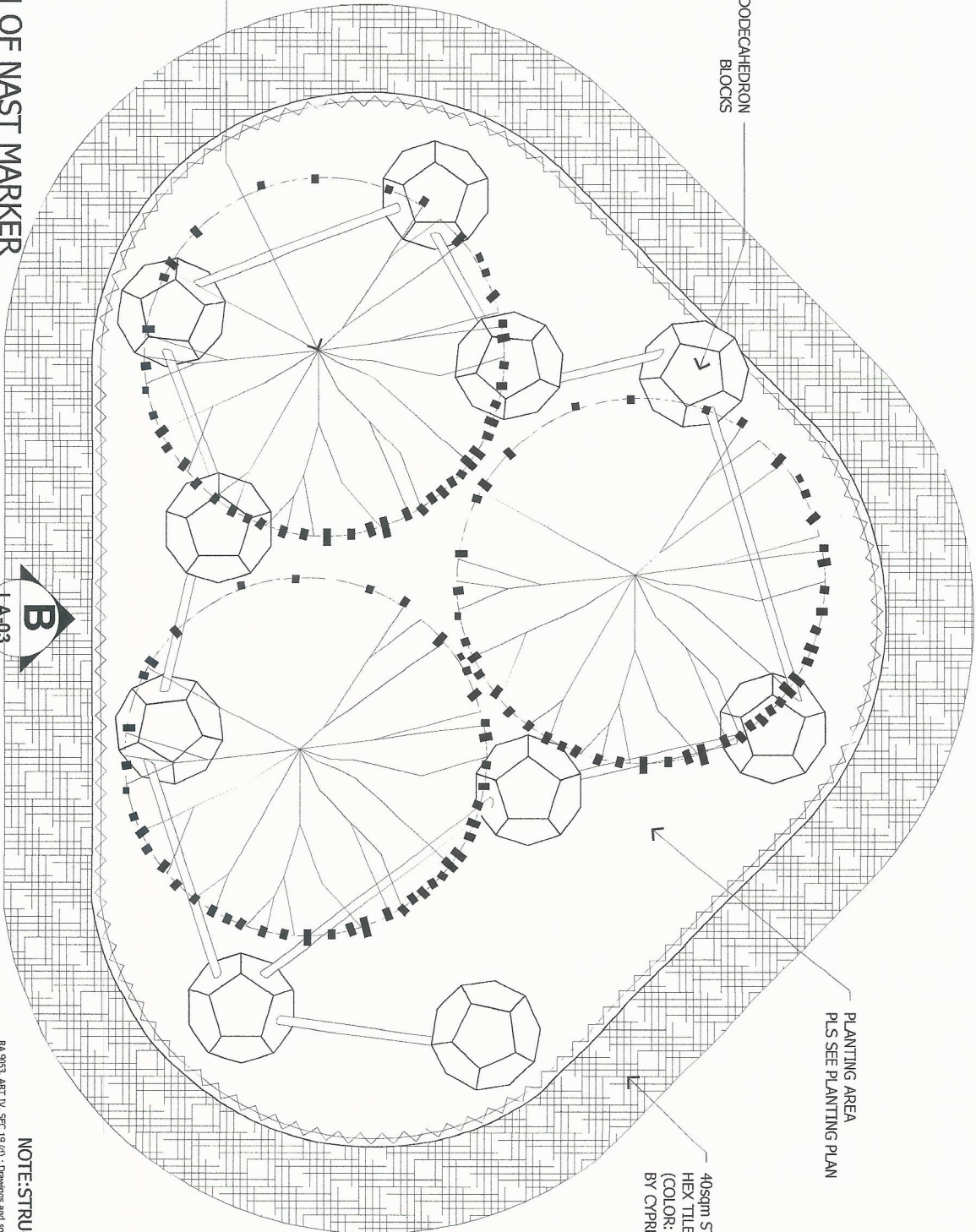

PLANTING AREA
PLS SEE PLANTING PLAN

40sqm STAMPED CONCRETE
HEX TILE PATTERN
(COLOR: SHALE GRAY)
BY CYPRESS BOMANITE



NORTH

NOTE: STRUCTURAL BY OTHERS

LA-03

A LANDSCAPE PLAN OF NAST MARKER

LA-01 SCALE

1:50M/TJS

LANDSCAPE ARCHITECT

CIVIL ENGINEER

REG. NO.

PROJECT

PROJECT OWNER

CONTENTS

REVISIONS

DRAWN BY

SHEET NO.

HOLTZ C. ABU

REG. NO. 138
DATE: 01/27/16
PLACE: OMAHUA
TIN: 291718-575

ENGINEER

DATE:
PLACE:
TIN:

**NAST COMMEMORATIVE
MARKER**
DOCT Complex, Beldun, Tiquig City

**National Academy of
Science and Technology**

LANDSCAPE PLAN

DRAWN BY: HCA
CHECKED BY: HCA
DATE: 1/28/16

LA-01
PROJECT NO.
01-2016

PA 9933, ART IV, SEC 19 (G): Drawings and specifications duly signed, stamped or sealed as instruments of service are the property and documents of the Landscape Architect, whether the project for which they were made is executed or not. No person without the written consent of the Landscape Architect or holder of said documents shall duplicate or make copies of said documents or parts thereof for the execution of and for other projects or buildings, whether executed partly or in whole.

A TYPICAL DETAIL OF SCULPTURE LA-03 SCALE 1:25M/TS

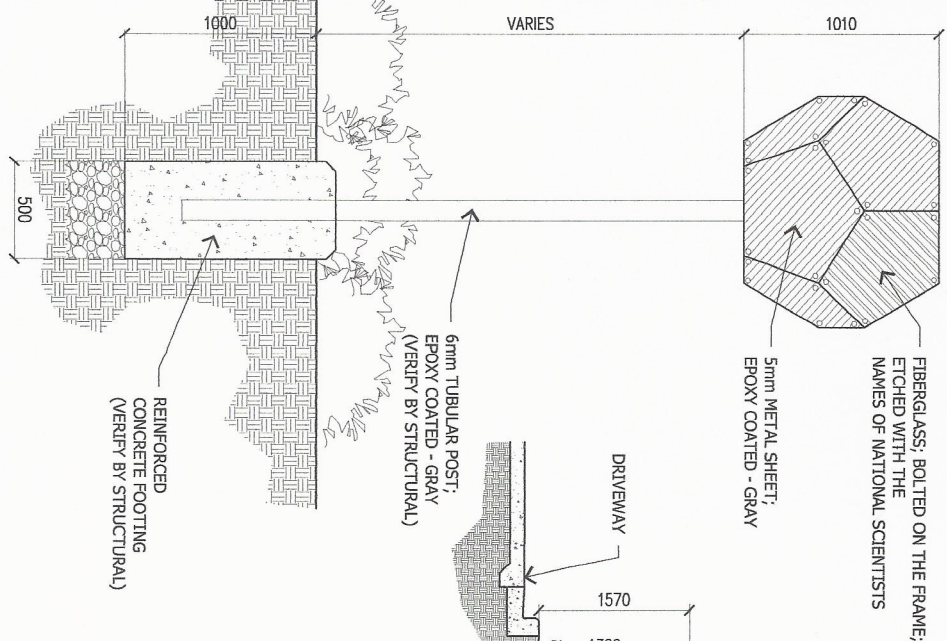

B ELEVATION OF SCULPTURE LA-03 SCALE 1:50M/TS

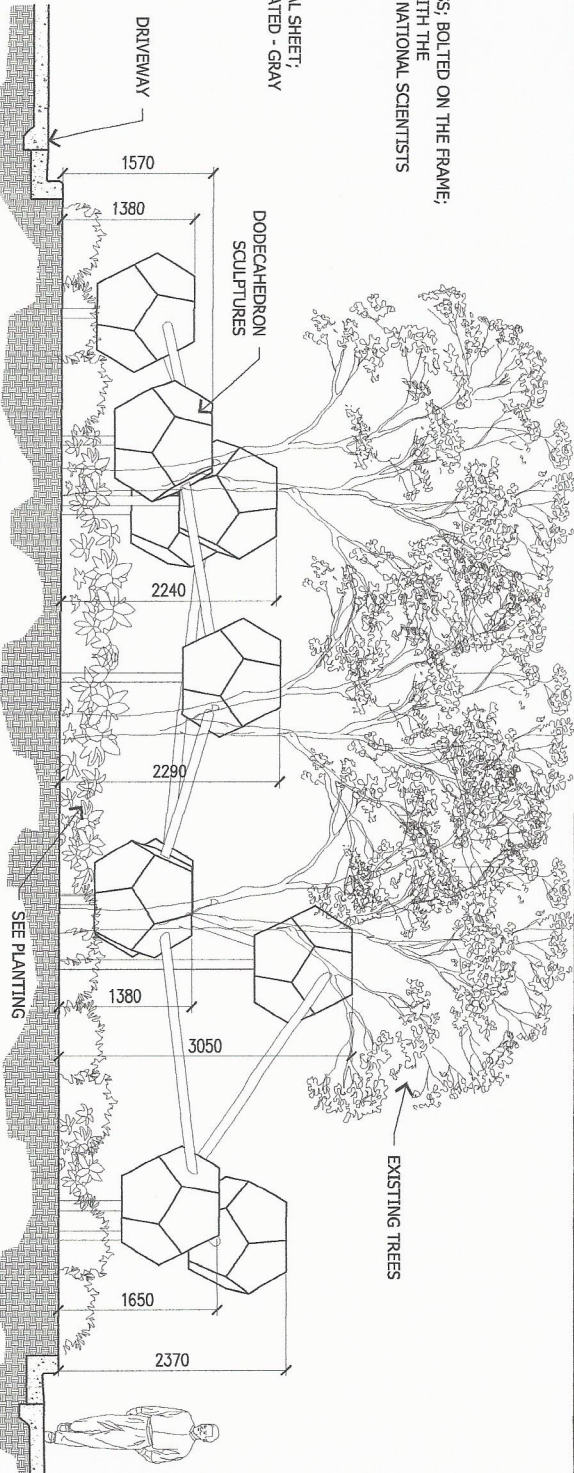

C DETAIL OF DODECAHEDRON LA-03 SCALE 1:50M/TS

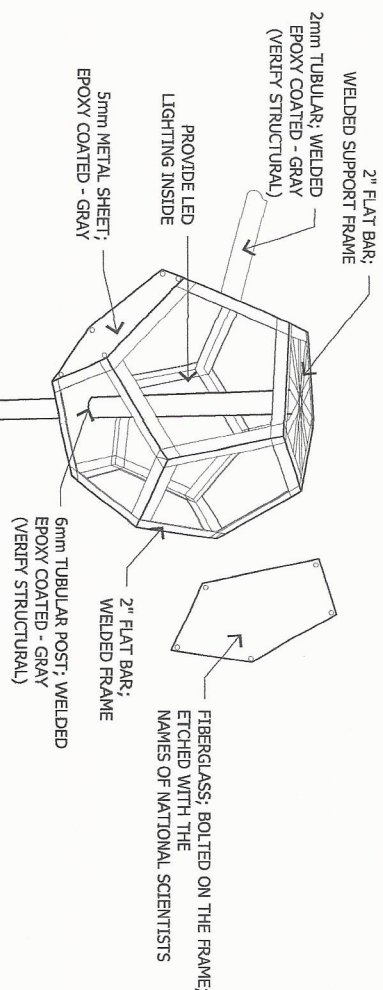

LANDSCAPE ARCHITECT	REG. NO. 148	CIVIL ENGINEER	REG. NO.	PROJECT	CONTENTS	REVISIONS	SHEET NO.
HOLTZ C. ABBU	DATE: 01/27/16	ENGINEER	DATE:	MAST COMMEMORATIVE MARKER	DETAILS	DATE: 01/27/16	LA-03
	PLACE: CHICAGO		PLACE:	DOST Complex Bldg., 1st fl. City	National Academy of Science and Technology	DATE: 01/27/16	PROJECT NO.
	TIN: 201-718-975		TIN:			DATE: 01/27/16	01-2016

NOTE: STRUCTURAL BY OTHERS

RA 9053, ART IV, SEC 19 (d) : Drawings and specifications duly signed, stamped or sealed as instruments of service, are the property and documents of the Landscape Architect, and shall remain the property of the Landscape Architect. No part of the drawings or specifications shall be reproduced, copied, or used in any way without the written consent of the Landscape Architect or author of said documents and duplicate or make copies of said documents for use in the rendition of and for other projects or buildings, whether executed partly or in whole.

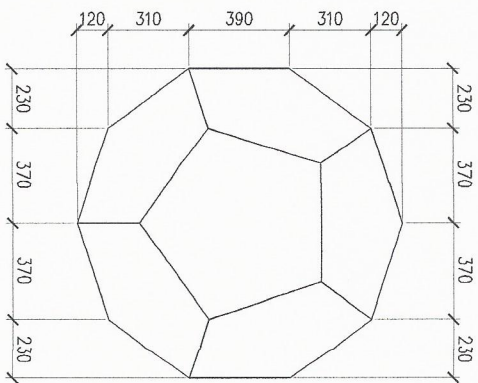

TOP

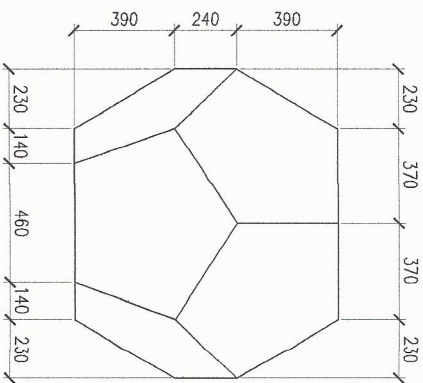

FRONT

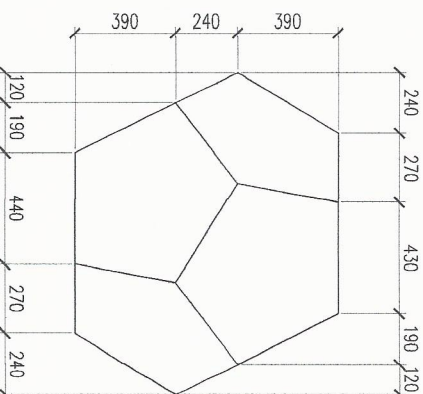

RIGHT

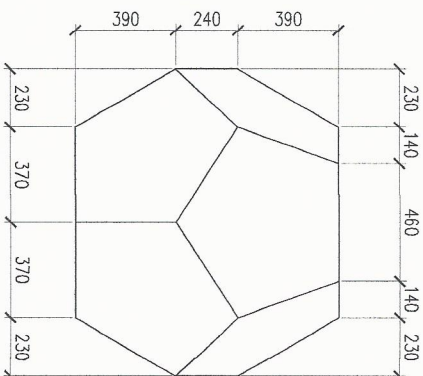

BACK

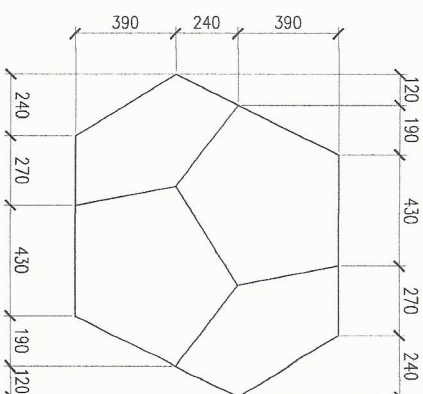

LEFT

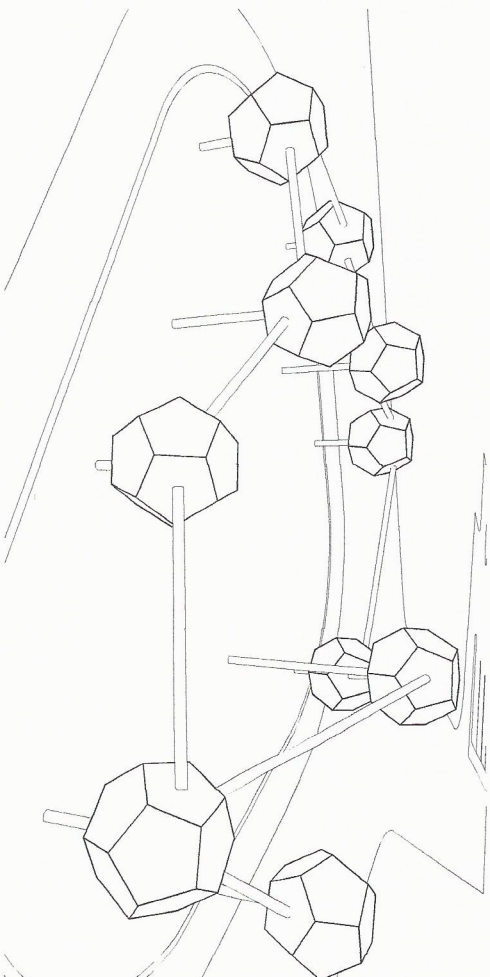

PERSPECTIVE

A DETAIL OF DODECAHEDRON BLOCK
LA-04 SCALE NTS

NOTE:STRUCTURAL BY OTHERS

LANDSCAPE ARCHITECT	REG. NO. 138	CIVIL ENGINEER	REG. NO.	PROJECT	PROJECT OWNER:	CONTENTS:	REVISIONS:	SHEET NO.
HOLTZ, C. ABBU	PTR. NO. 1160990 DATE: 01/27/16 PLACE: GARGIN TR: 201-718-575	ENGINEER	PTR. NO. DATE: PLACE: TR:	NAST COMMEMORATIVE MARKER DOST Complex Blduan, Tanjung City	National Academy of Science and Technology	DETAILS	HCA DATE: 12/16/16 CHECKED BY: HCA DATE: 12/16/16	LA-04 PROJECT NO. 01-2016

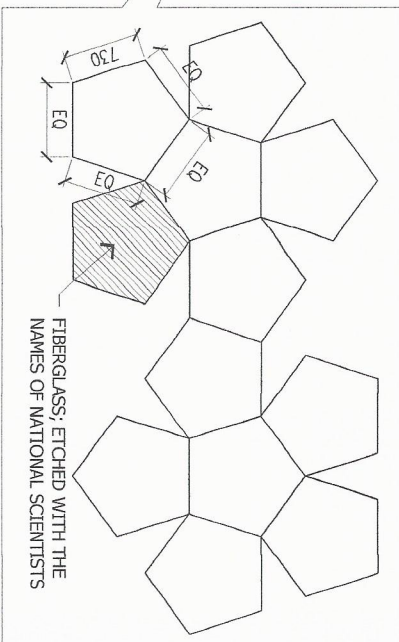

TYPICAL DODECAHEDRON BLOCK

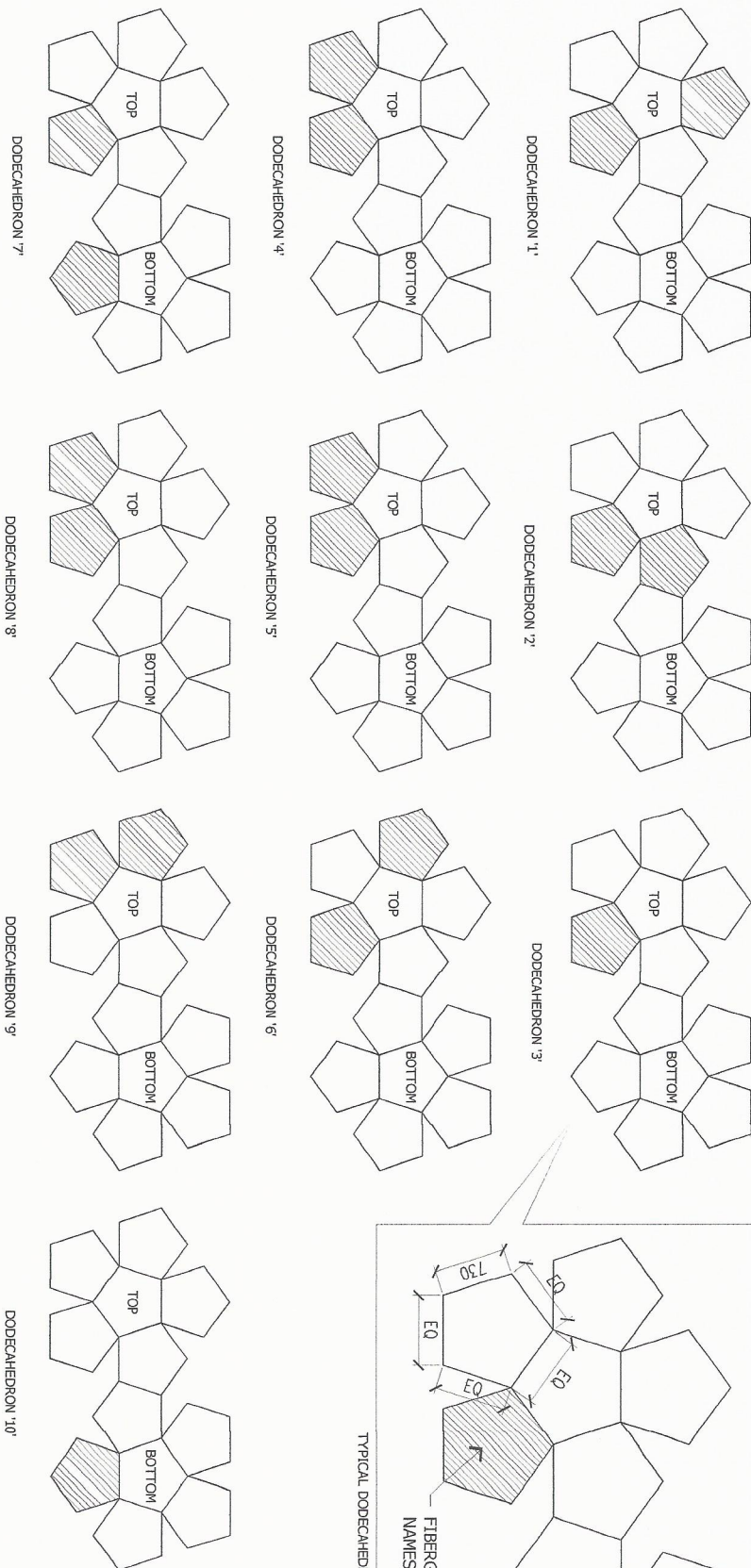

A DETAILS OF DODECAHEDRON BLOCKS LA-05 SCALE 1:50MTS

LANDSCAPE ARCHITECT		REG. NO. 138		CIVIL ENGINEER		REG. NO.		PROJECT:		PROJECT OWNER:		CONTENTS:		REVISIONS:		SHEET NO.	
HOLTZ C. ABBU		PR. NO. 1109960		ENGINEER		DATE: 01/27/16		NAST COMMEMORATIVE MARKER		National Academy of Science and Technology		DODECAHEDRON DETAILS		HCA		LA-05	
PLACE: CHANGJUN		DATE: 01/27/16				TIN: 281718-575		DOST Complex Bldg., Hanoi City						DATE: 01/28/16		PROJECT NO.	
																01-2016	

NOTE: STRUCTURAL BY OTHERS

PA 9053, ART IV, SEC 19 (g): Drawings and specifications duly signed, stamped or sealed as instruments of service are the property and documents of the Landscape Architect, whether the project for which they were made is executed or not. No person without the written consent of the Landscape Architect or author of said documents shall duplicate or use the same in whole or in part for any other project or for other projects or buildings, whether executed partly or in whole.



345pcs PICARRA
Excoecaria cochinchinensis
@200mm O.C.

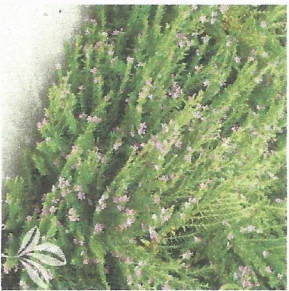

767pcs SINGAPORE BUSH
Cuphea hyssopifolia
@150mm O.C.

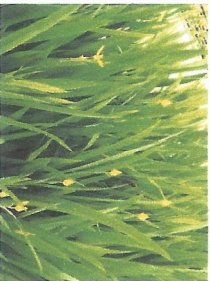

1,380pcs YELLOW IRIS
Neomarica longifolia
@100mm O.C.

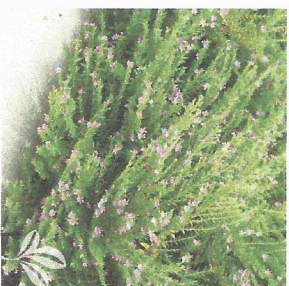

614pcs SINGAPORE BUSH
Cuphea hyssopifolia
@150mm O.C.



748pcs PICARRA
Excoecaria cochinchinensis
@200mm O.C.



A PLANTING PLAN

LA-06 SCALE 1:50MTS

RA 9053, ART IV, SEC 19 (9) : Drawings and specifications duly signed, stamped or sealed as instruments of service are the property and documents of the Landscape Architect, whether the project for which they were made is executed or not. No person without the written consent of the Landscape Architect or his/her firm shall duplicate or make copies of all documents issued by the Landscape Architect for the purpose of the project or buildings, whether executed partly or in whole.

LANDSCAPE ARCHITECT	138	CIVIL ENGINEER	REG. NO.	PROJECT	CONTENTS	REVISIONS:	SHEET NO.
	PTR. NO. 116999		DATE:	PROJECT NAME:	PLANTING PLAN	NO.	LA-06
	DATE: 01/27/16		PLACE:	PROJECT LOCATION:		CHECKED BY:	PROJECT NO.
	PLACE: CANGILIN	ENGINEER	TIN:	PROJECT ADDRESS:		HCA	01-2016
	TIN: 291-718-975					DATE: 1/27/16	

HOLTZ C. ABBU